



TEAM HANDBOOK

AMERICAN FESTIVAL OF ROME
19.05.2024

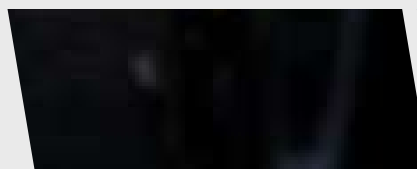
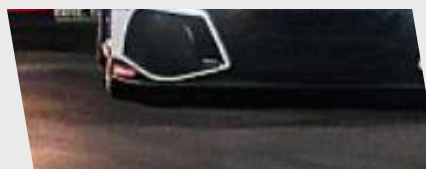

TABLE OF CONTENTS

GENERAL INFORMATION

TIMETABLE

OFFICES

MAPS

VIRTUAL TOUR

PHOTOGRAPHERS MAP

Paddock LAYOUT

TEAM PARKING AREA

CONTACTS



GENERAL INFORMATION

- 1 MAIN ENTRANCE
- 2 RACE CONTROL; STEWARDS OFFICES; TIMEKEEPERS; RACE SECRETARIAT
- 3 MEDICAL CENTRE
- 4 MEDIA CENTRE
- 5 PODIUM
- 6 SCRUTINEERING BAY
- 7 PRE-GRID ZONE
- 8 BAR/RESTAURANT



HOW TO GET

from Rome

GRA - Exit no. 5: "Cassia Veientana" - straight ahead on the SS 2 Cassia up to km.34.5 - then go out to right: signs "Vallelunga" - continue straight ahead for 2 km, then left on the racetrack entrance indicated by appropriate signs.

from Naples

Motorway A1, exit Roma Sud, then take the ring road clockwise - Exit no. 5 "Cassia Veientana" - straight ahead on S.S.2 Cassia up to km. 34.5 - then go out to right: signs "Vallelunga" - continue straight ahead for 2 km, then left on the racetrack entrance indicated by appropriate signage

from Florence

Motorway A1, exit Magliano Sabina, S.S. 3 Flaminia to Civita Castellana and continue to Nepi SS 2 Cassia (direction to Rome) to km. 34.5 then follow the signs "Vallelunga", continue straight ahead for 2 km, then left on racetrack entrance indicated by appropriate signage

from Fiumicino Airport

Rome-Fiumicino motorway, exit GRA (direction to Firenze) . Exit no. 5: "Cassia Veientana" -straight ahead on the SS 2Cassia up to km. 34.5 - then go out to right: signs "Vallelunga" - continue straight ahead for 2 km, then left on the racetrack entrance indicated by appropriate signs.

GENERAL INFORMATION

ACCREDITATION CENTRE

TRUCKS - *TEMPORARY TRUCKS PARKING AREA*

ENTRANCE - *CIRCUIT MAIN ENTRANCE*

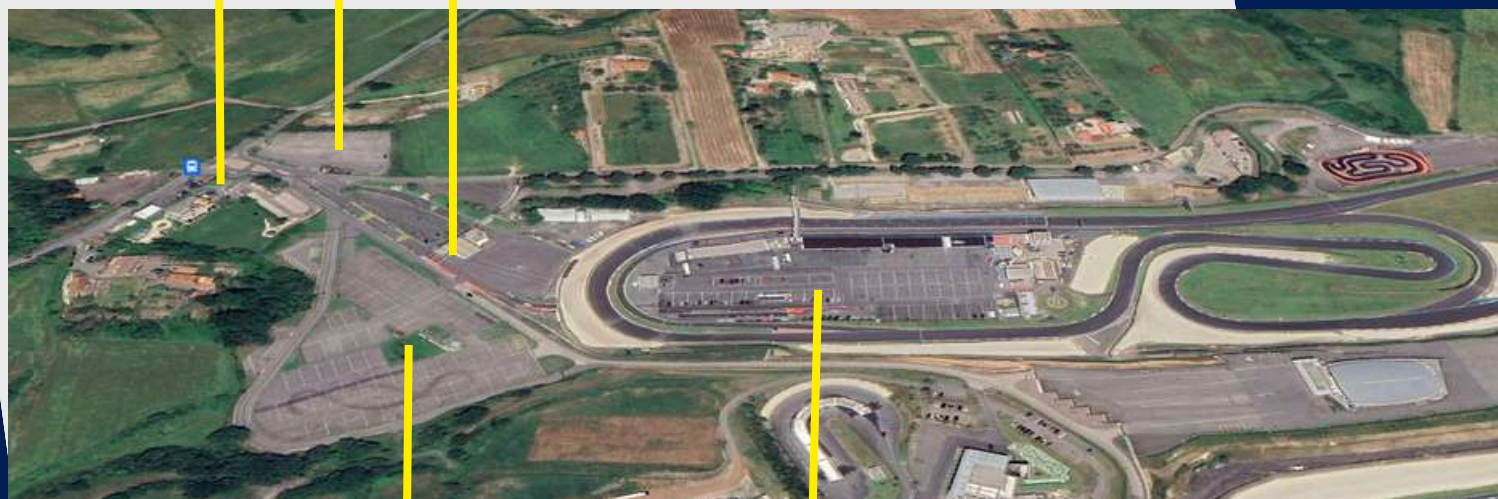

P0 - *MAIN PADDOCK*

P3/P4 - *TEAM PARKING AREA*

GENERAL INFORMATION



ACI VALLELUNGA SPA

Via Mola Maggiorana, 4
00063 - Campagnano di Roma (RM)



+39.06.90.15.50.1



AUTODROMO@VALLELUNGA.IT



TIMETABLE

AMERICAN FESTIVAL OF ROME

Autodromo "Piero Taruffi" Vallelunga
Provisional event timetable v.1_03.05.2024

Autodromo Vallelunga
Piero Taruffi



Thursday May 16th

BN 2 - EN PRO	09.00 - 20.00	Paddock access for team set-up
All categories	14.30 - 20.00	Paddock access for team set-up
All categories	-	On-line Administrative checks
All categories	15.00 - 18.00	Transponders collection @ 1st floor Race Control Tower

Friday May 17th

All categories	07:30 - 20:30	Paddock access for team set-up	
All categories	-	On-line Administrative checks	
	BRIEFING	TRANSPONDER COLLECTION	SCRUTINEERING
EuroNASCAR PRO	TBA	07.00 - 17.00	09.00 - 18.00
EuroNASCAR 2			
TCR Endurance	12.00		
Legend Cars	10.40		

START	END	CATEGORY	SESSION	LENGHT	BREAK
09:00	09:30	Club Challenge	Session 1	30'	00:05
09:35	09:55	Legend Cars	Free Practice 1	20'	00:10
10:05	10:35	Club Challenge	Session 2	30'	00:05
10:40	11:05	BREAK		25'	00:05
11:10	11:40	Club Challenge	Session 3	30'	00:05
11:45	12:05	Legend Cars	Free Practice 2	30'	00:05
12:10	13:20	BREAK		70'	00:05
13:25	13:55	TCR Endurance	Free Practice 1	30'	00:05
14:00	14:30	EuroNASCAR PRO	Practice 1	30'	00:10
14:40	15:10	EuroNASCAR 2	Practice 1	30'	00:05
15:15	15:45	BREAK		30'	00:10
15:55	16:15	Legend Cars	Free Practice 3	20'	00:15
16:30	17:00	EuroNASCAR PRO	Practice 2	30'	00:10
17:10	17:40	EuroNASCAR 2	Practice 2	30'	00:25
18:05	18:35	TCR Endurance	Free Practice 2	30'	

Saturday May 18th

START	END	CATEGORY	SESSION	LENGHT	BREAK
09:00	09:20	Legend Cars	Qualifying 1	20'	00:15
09:35	09:55	Legend Cars	Qualifying 2	20'	00:05
10:00	10:15	EuroNASCAR PRO	Qualifying	15'	00:05
10:20	10:25	EuroNASCAR PRO	Superpole	5'	00:15
10:40	11:00	EuroNASCAR 2	Qualifying	20'	00:35
11:35	12:05	Legend Cars	Race 1	20'	00:05
12:10	12:50	TCR Endurance	Qualifying (15'-10'-15')	40'	00:05
12:55	13:25	BREAK		30'	00:05
13:30	14:00	"Live the Grid" - Spectators on starting grid		30'	00:15
14:15	15:00	EuroNASCAR PRO	Race 1	18 laps	00:20
15:20	16:20	TCR Endurance	Race 1	55'	00:20
16:40	17:10	Legend Cars	Race 2	30'	00:35
17:45	18:25	EuroNASCAR 2	Race 1	15 laps	

Sunday May 19th

START	END	CATEGORY	SESSION	LENGHT	BREAK
09:00	09:10	EuroNASCAR PRO / 2	Warm Up	10'	00:20
09:30	10:00	Legend Cars	Race 3	20'	00:30
10:30	11:10	EuroNASCAR 2	Race 2	15 laps	00:20
11:30	12:30	TCR Endurance	Race 2	55'	00:10
12:40	13:35	BREAK		55'	00:10
13:45	14:15	"Live the Grid" - Spectators on starting grid		30'	00:15
14:30	15:15	EuroNASCAR PRO	Race 2	18 laps	00:20
15:35	16:05	Legend Cars	Race 4	20'	



WWW.VALLELUNGA.IT
www.euroNASCAR.com



OFFICES

GROUND FLOOR - RACE CONTROL TOWER

- 1 *Race Control*
- 2 *Race Director Office*
- 3 *Stewards Panel*
- 4 *Race Secretariat*
- 5 *Vallelunga Office*
- 6 *Race Secretariat - Front Office*

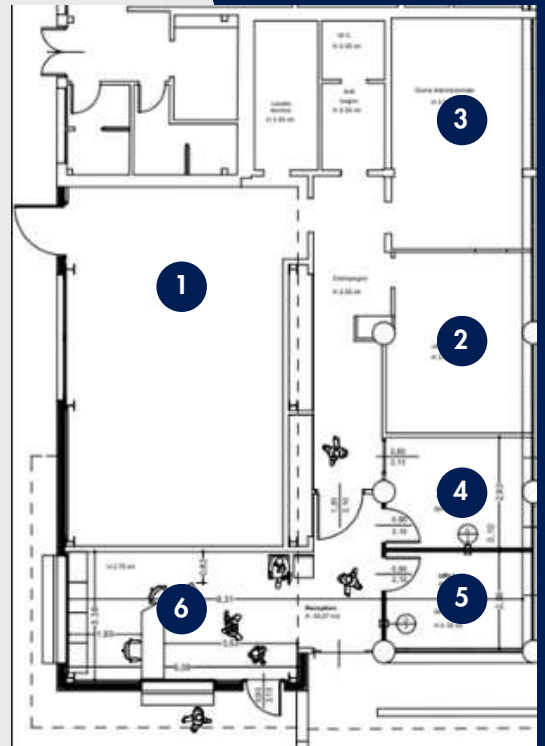

1ST FLOOR - RACE CONTROL TOWER

- 1 *Front Office - Administrative checks - Free practice Transponder collection*
- 2 *NASCAR Office*
- 3 *NASCAR Director Office*
- 4 *TCR Office*

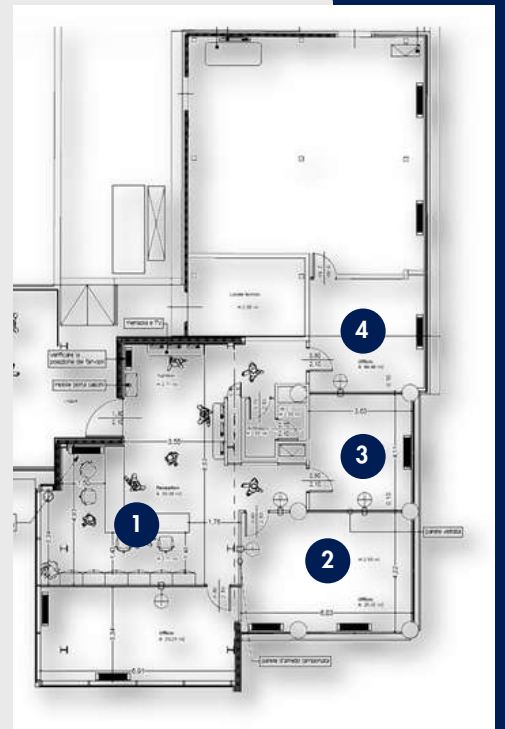

MAPS



Lap Length	4.085m
Direction	clockwise
Pole Position	RHS
Speed limit in pitlane	60 km/h
Practice starts	close to pit exit line at the RHS
Start and finish line	are the same (line offset: 0.0 m)
Location of pit exit in relation to the Line:	42 m
SC line 1	at the pit entry
SC line 2	at the end of the pit exit
SC initial positions	T13
SC during the race	pit exit
SC lights off	T10

MAPS

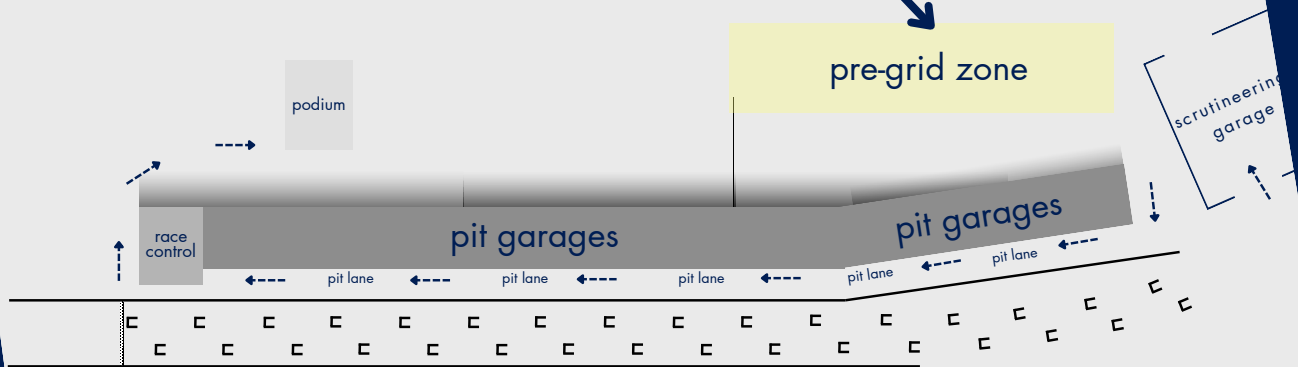
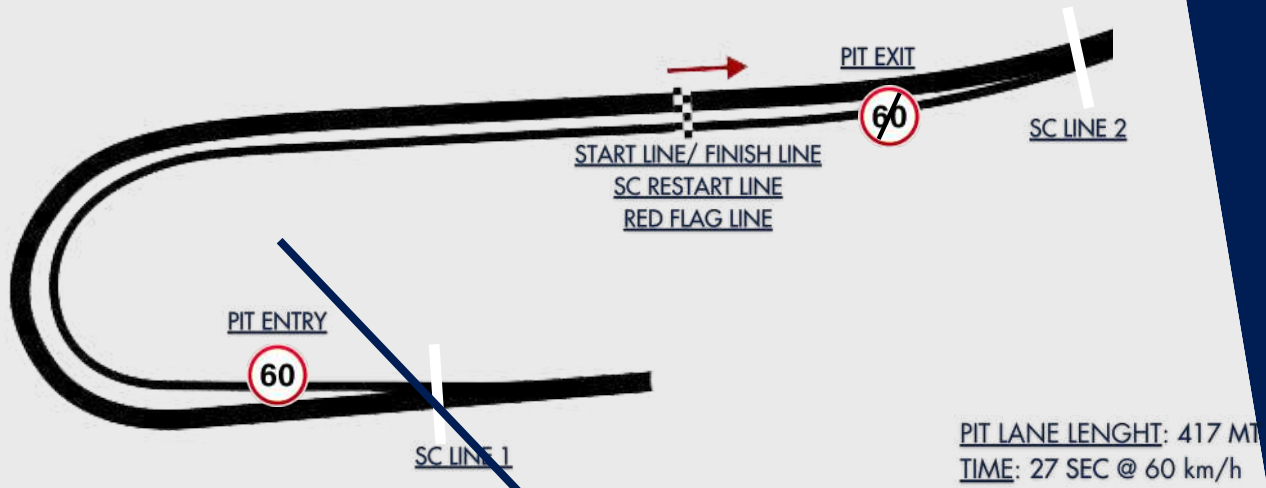

VIRTUAL TOUR

START/FINISH & T 1



T 2 & T 3



T 4 & T 5

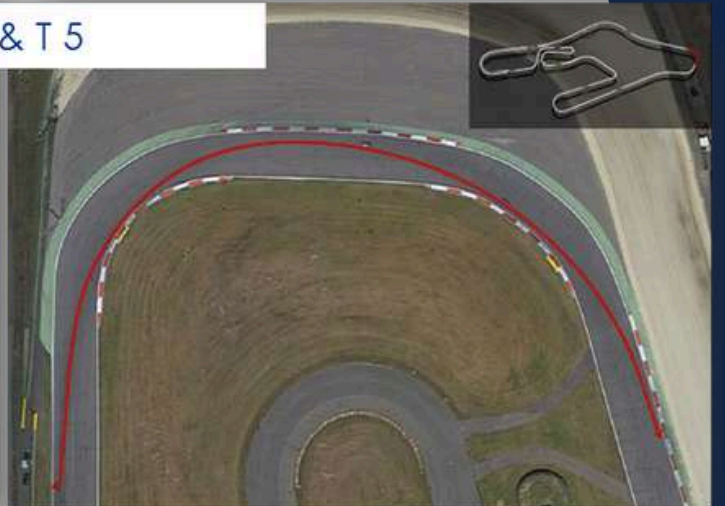

VIRTUAL TOUR

T 6 & T 7



T 7

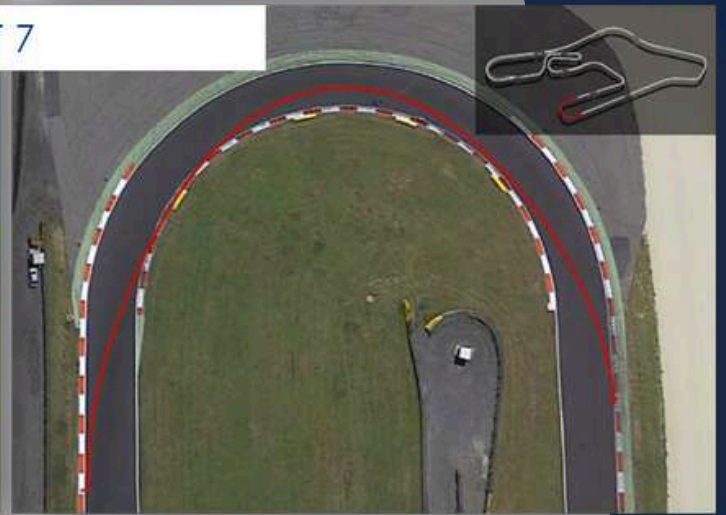

T 8

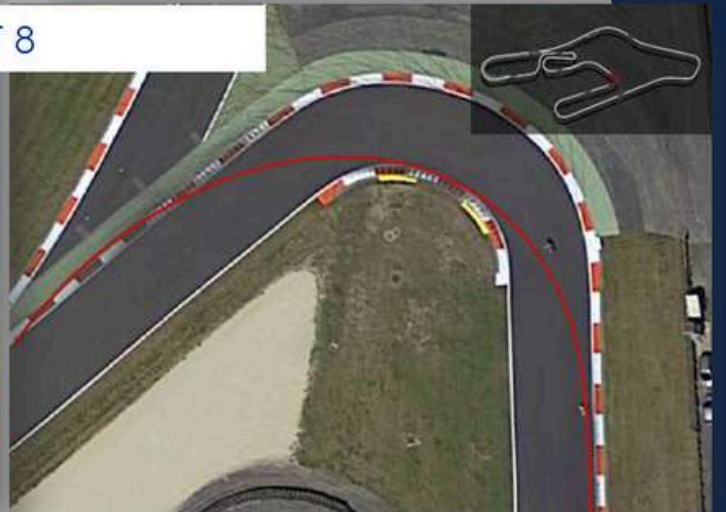

VIRTUAL TOUR

T 9

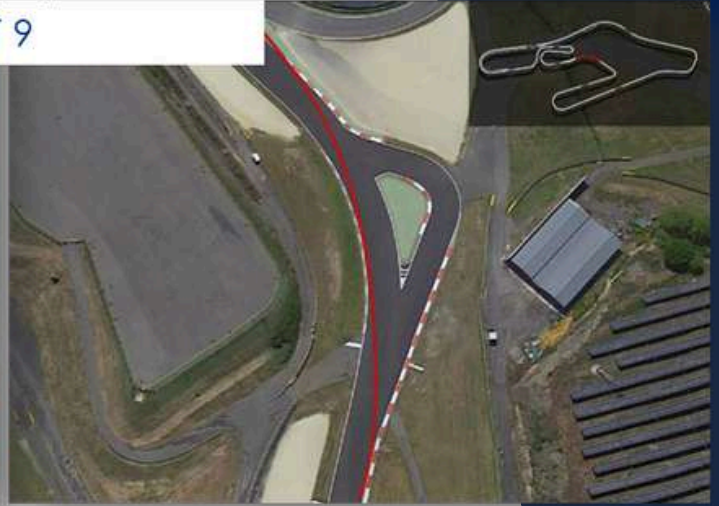

T 10



T 11

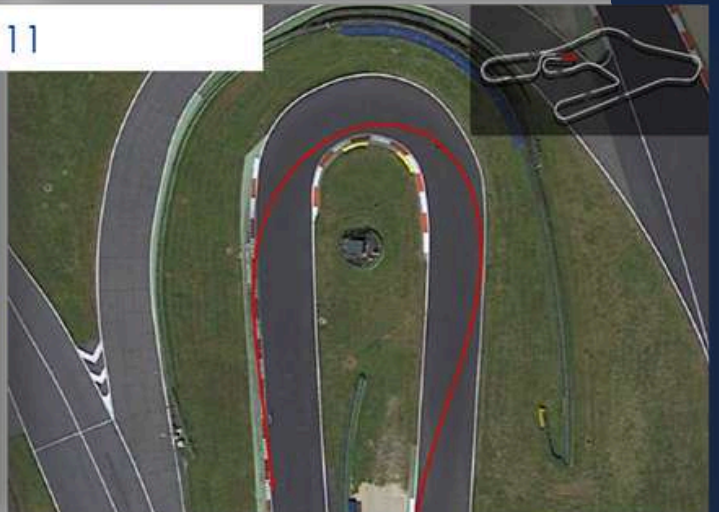

VIRTUAL TOUR

T 12



T 13

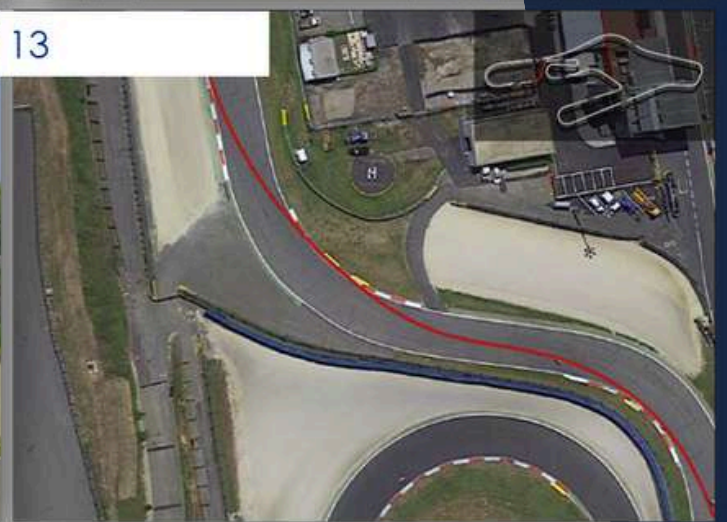

T 14

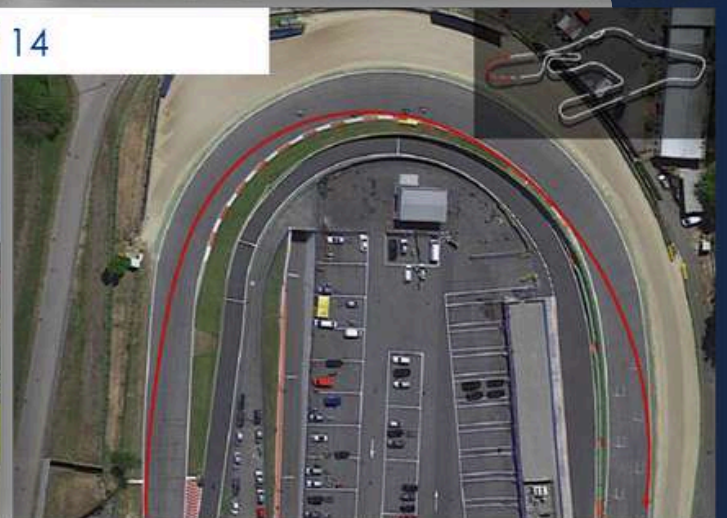

PHOTOGRAPHERS MAP

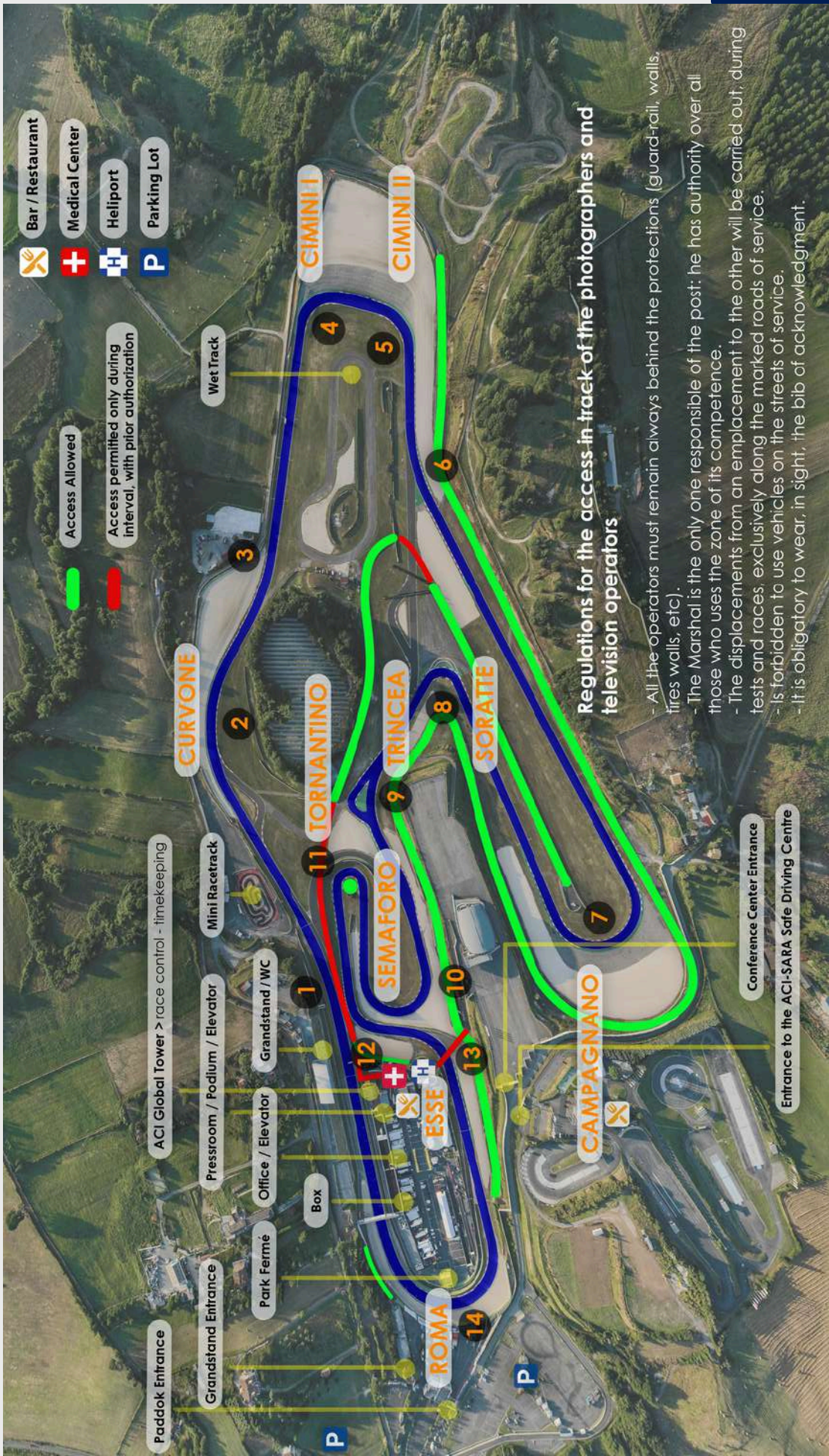

Paddock Layout

P0 - MAIN PADDOCK

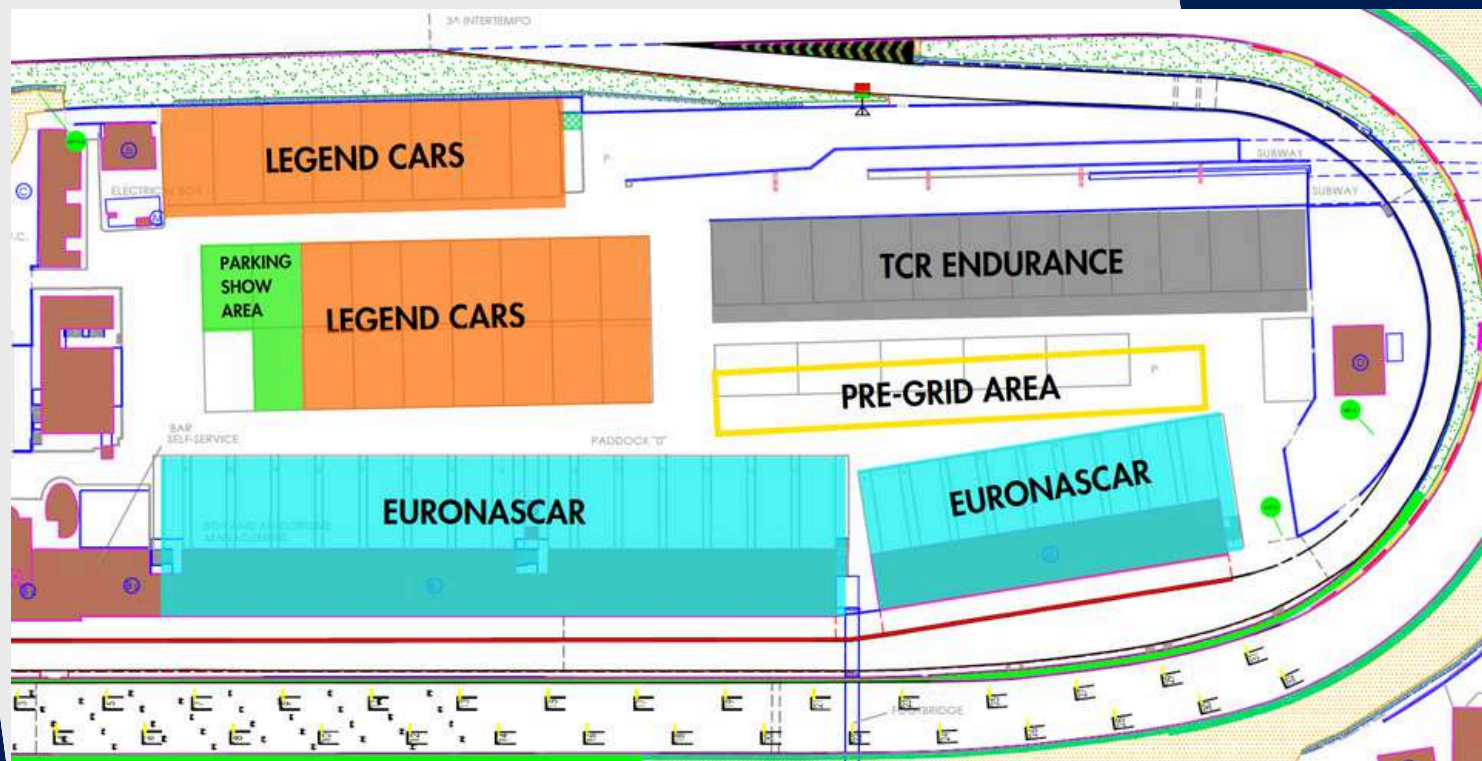

P1 - ENTRANCE PADDOCK

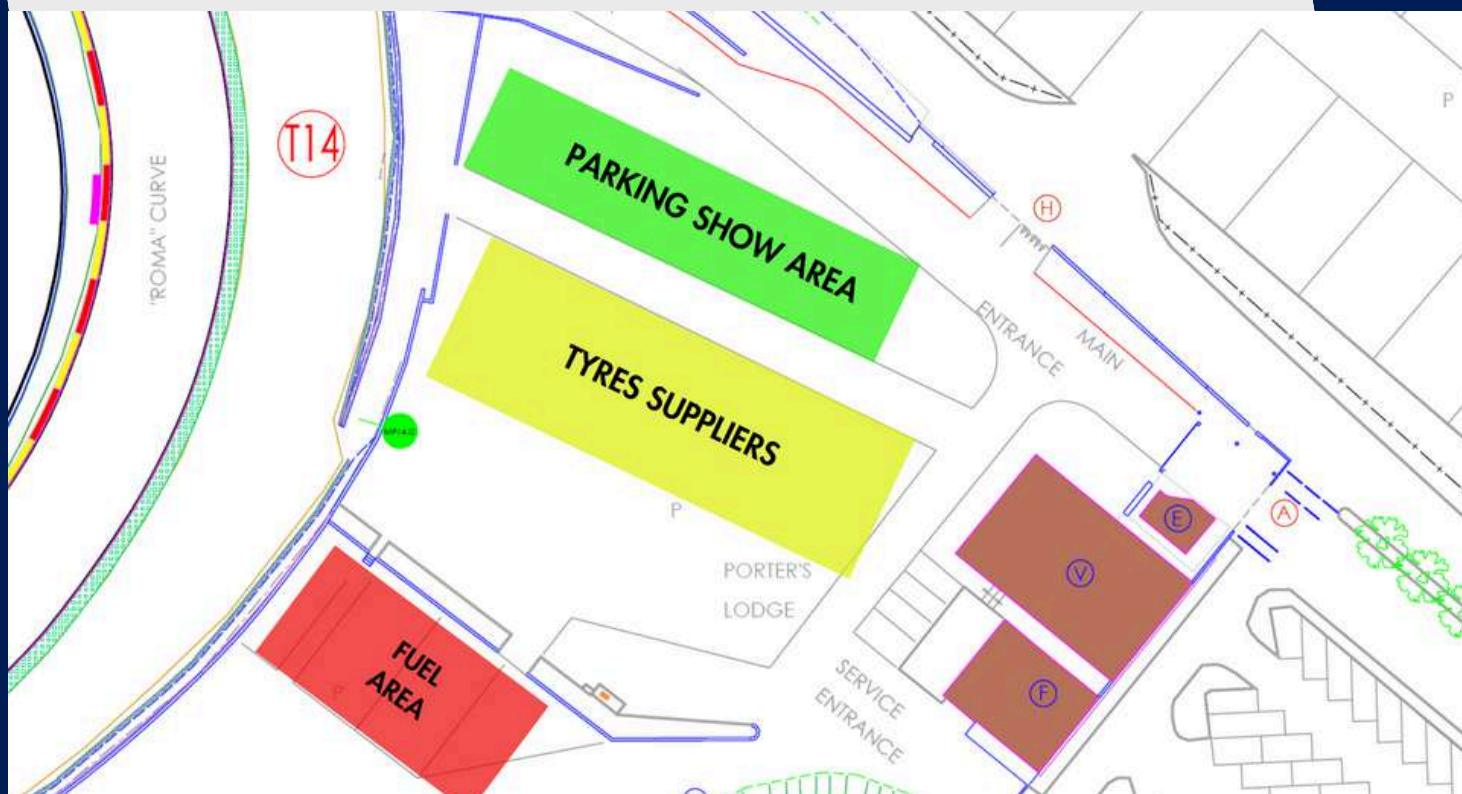

TEAM PARKING AREA

PARKING AREA - P3/P4

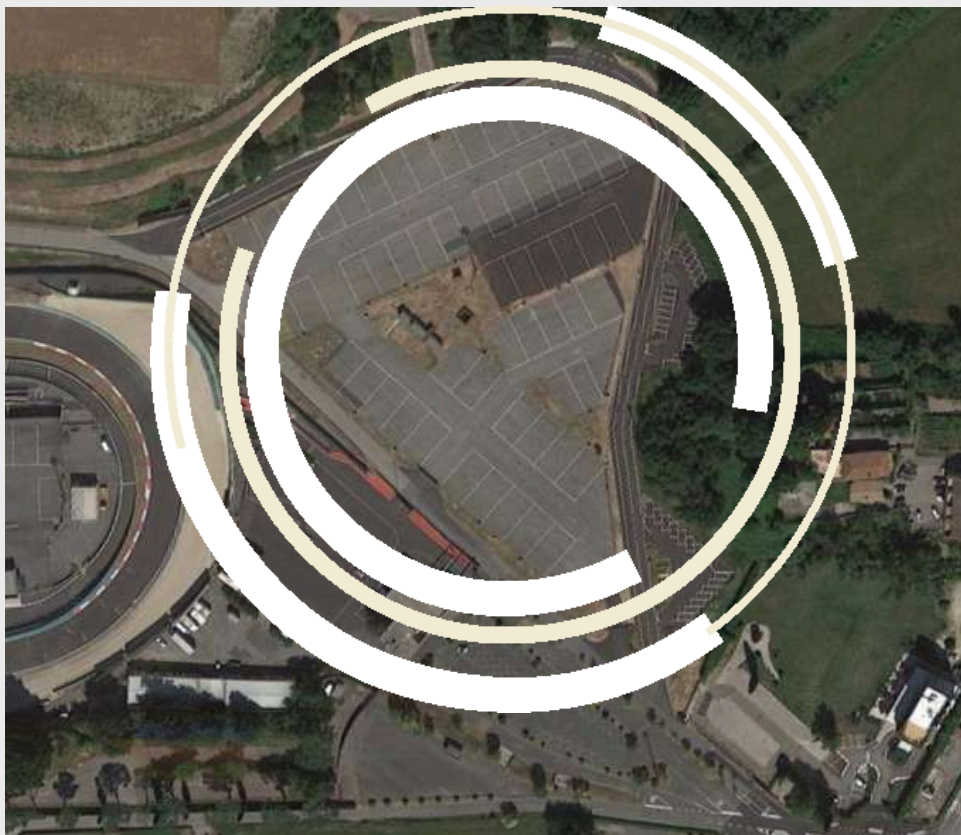
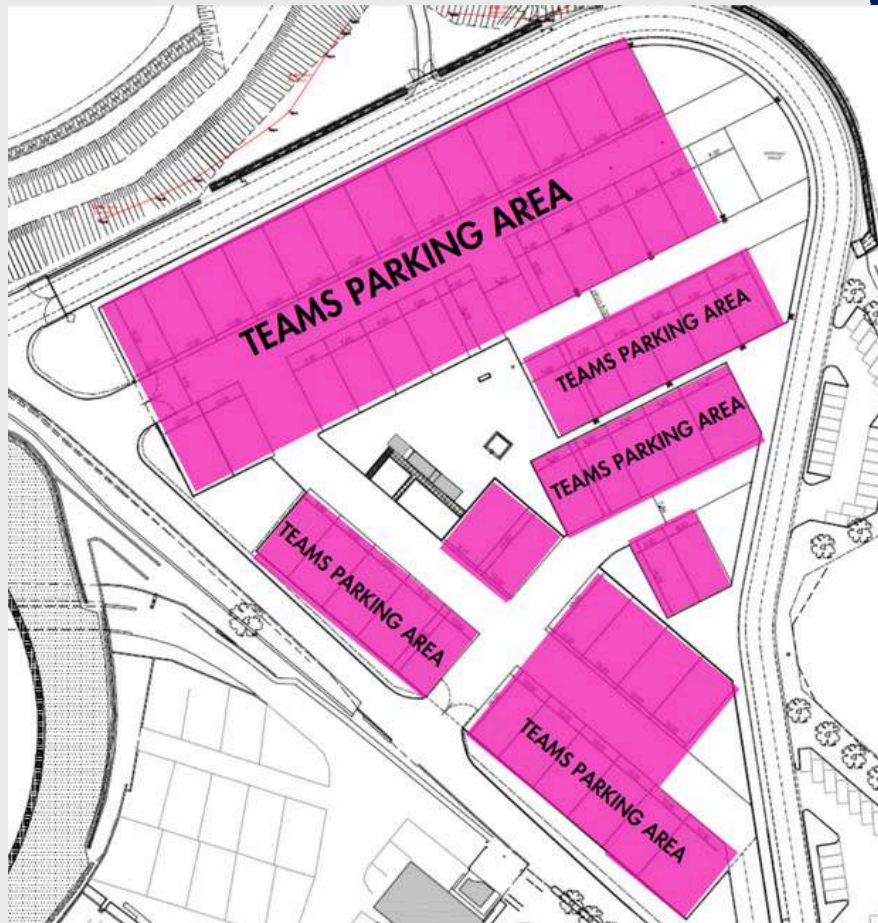

CONTACTS

FRANCESCO CASSIOLI

Circuit Commercial Responsible and
Activity Coordinator



+39.06.90.15.50.68
+39.366.66.30.151
cassoli@vallelunga.it

DINO ADLO LODOLA

Head of Sport Office



+39.06.90.15.50.69
+39.337.13.80.672
lodola@vallelunga.it

FABIO SEVERINI

Digital Marketing & Communication
Specialist



+39.06.90.15.50.61
+39.345.79.71.933
severini@vallelunga.it

MARIA LUISA DE LUCA

Circuit commercial and Secretary Office



+39.06.90.15.50.16
deluca@vallelunga.it
info@vallelunga.it

ALESSIA ANGELILLO

Circuit commercial and Secretary
Office



+39.06.90.15.50.51
angelillo@vallelunga.it
provelibere@vallelunga.it

FRANCESCO BOZZO

Administrative Office Responsible



+39.06.90.15.50.43
bozzo@vallelunga.it

GIANFRANCO BONIFACIO

Technical Office Responsible



+39.06.90.15.50.14
+39.335.52.07.450
bonifacio@vallelunga.it

GIAMPIERO GAMBARDILLA

Technical Office



+39.06.90.15.50.18
+39.335.10.00.588
gambardella@vallelunga.it

ALESSANDRO CICCIA

Technical area planning
Safety and Quality



+39.06.90.15.50.15
+39.345.66.52.681
ciccia@vallelunga.it



ENJOY THE RACING WEEKEND

